

ORDER GRANTING PERMIT AND RIGHT-OF-WAY
TO CONSTRUCT PIPELINE

STATE OF TEXAS X Atmos Energy Corporation
X
COUNTY OF MONTAGUE X

Now, on this the **13TH DAY OF June, 2022**, at a regular Term and Session of the Commissioner's Court of Montague County, Texas, came to be considered the application of Atmos Energy Corporation for a permit and right-of-way to lay, construct, maintain, operate a ROAD CROSSING on TAGE ROAD of the County of Montague, State of Texas, and the court having considered such application and is here referred to and made a part hereof, and having determined that the permit and right-of-way for such pipeline should be granted, it is accordingly ordered by the Court:

- 1. That the County of Montague, State of Texas, does hereby grant the right, privilege and right-of-way to Atmos Energy Corporation, to lay, construct, maintain, operate a pipeline along, over, across or under the public roads, streets, alleyways of the County of Montague, State of Texas.
- 2. That such pipeline shall be so buried, cased or uncased, covered, constructed and maintained as not to interfere with the use and occupancy of such roads by public. Said pipeline shall be buried 3 feet-cased or 6 feet-uncased below bar ditches.
- 3. That any adjustments of said pipeline required for any State Farm to Market Road or any other improved road would be at 100 per cent cost to Atmos Energy Corporation.
- 4. That all the rights, privileges and right-of-way herein above mentioned are by this order duly vested in said Atmos Energy Corporation, its successors and assigns, without further grant or procedure.

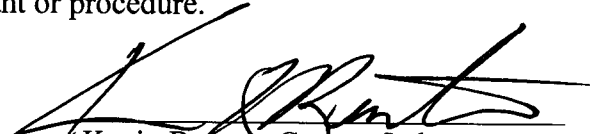

Kevin Benton, County Judge

STATE OF TEXAS X Atmos Energy Corporation
X
COUNTY OF MONTAGUE X

Before me, the undersigned authority, on this personally appeared Kevin Benton, known to me to be the person whose name is subscribed to the foregoing instrument and acknowledged to me that he executed the same for the purposes and consideration therein expressed and in the capacity therein stated.

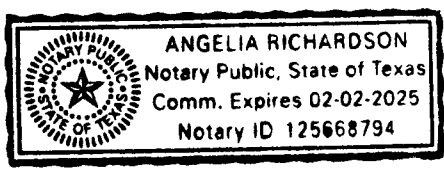
Given under my hand and seal of office this 13th day of June, 2022.
My commission expires:

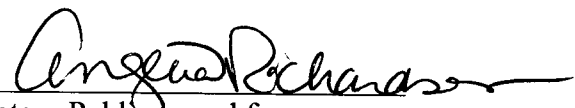

Notary Public in and for
Montague County, Texas

MONTAGUE COUNTY
APPLICATION FOR A PERMIT AND RIGHT-OF-WAY

DATE: 5/4/2022

NAME: ATMOS ENERGY

ADDRESS: 5430 LBJ Freeway DALLAS, TX 75240

CONTACT PERSON: JUSTIN WALKER TELEPHONE NO. 940-841-0942

ROAD NAME: TAGE RD. COMMISSIONER PCT. 1 (2) 3 4

GPS Coordinates: Latitude _____ Longitude _____

(GPS Coordinates for Road Crossings)
 TEMPORARY PERMANENT PLAT ATTACHED

This document is an application for a permit and right-of-way. Please give a descriptive explanation of the work to be done:

ATMOS ENERGY IS REPLACING THE WE-2 LINE THAT TRANS PORTS NATURAL GAS BETWEEN BOWIE + HOCONA. THE NEW LINE WILL PARALLEL THE EXISTING LINE. ATMOS IS REQUESTING A PERMIT TO BORE THIS RD. IN THE EXISTING ROW.

If your application for the permit and right-of-way is approved by the Montague County Commissioners Court and an Order to grant the permit and right-of-way for such pipeline or utility lines should be granted, the following is understood:

1. That such pipeline or utility lines shall be so buried, cased, covered, constructed and maintained as not to interfere with the use and occupancy of such roads by public.
2. That any adjustments of said pipeline or utility lines required for any State Farm to Market Road or any other improved road would be at 100 per cent cost to the applicant.
3. That all the rights, privileges and right-of-ways will be vested in said Applicant and its successors and assigns, without further grant or procedure.
4. Fees may or may not apply. If fees apply, fees need to accompany the application.
5. Notice of all applications will be sent to the Upper Trinity Groundwater Conservation District.
6. Utility lines shall be so buried at least 36 (thirty-six) inches in order to be able to maintain roads and ditches.

Type of Water Used:

Surface Water	_____	Percentage
Ground Water	_____	Percentage
Both	_____	Percentage

GPS Coordinates: Latitude _____ Longitude _____

Meter Serial Number: _____

Beginning Meter Reading (as displayed on meter): _____

Ending Meter Reading (as displayed on meter): _____

Location of the use of the water: _____ County: _____

Will any of this water be transported for use outside of the District (Montague, Parker, Wise, and Hood Counties)? Yes No

If yes, explain how the water was measured and include amount transported. _____

AFFIRMATION

I HEREBY SWEAR OR AFFIRM THAT THE INFORMATION INCLUDED IN THIS REPORT IS TRUE AND CORRECT TO THE BEST OF MY KNOWLEDGE.

DATE 5/31/2022

SIGNATURE JB. Welch

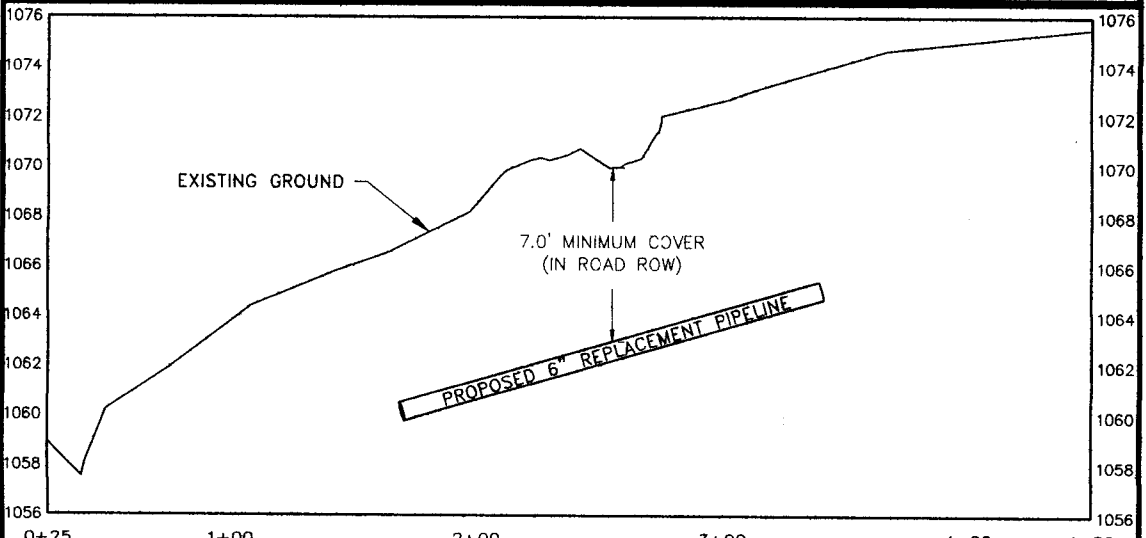
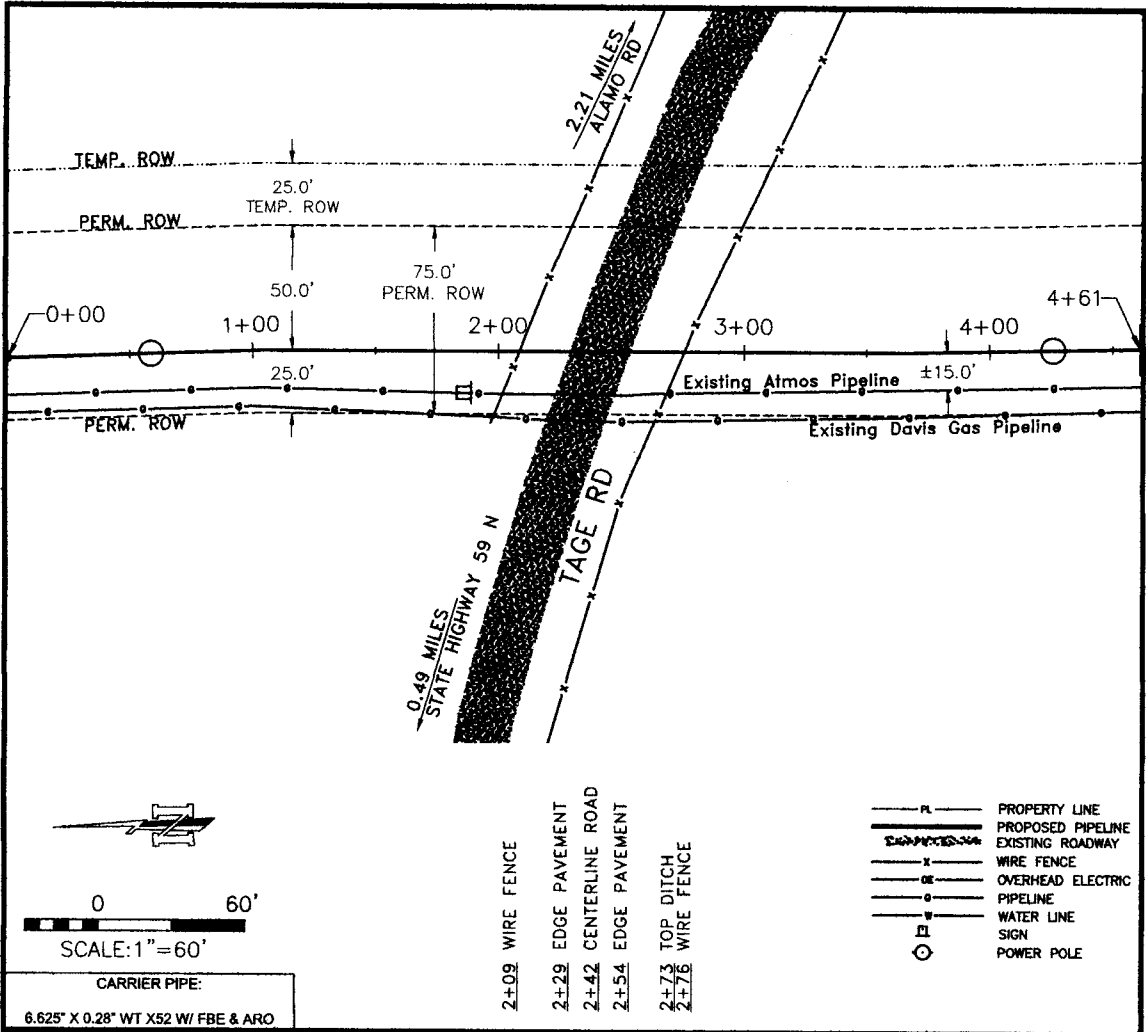

NOTES
1. ALL BEARINGS SHOWN HEREON ARE BASED UPON THE TEXAS STATE PLANE COORDINATE SYSTEM, NAD 83, NORTH CENTRAL ZONE (4202) AS DERIVED FROM GPS OBSERVATION.

KSA

140 E. Tyler St., Suite 600 Longview, Texas 75601
T. 903-236-7700 F. 903-236-7779
www.ksseng.com
TBPLS FIRM REG. NO. 1011500
TBPE FIRM REG. NO. F-1356

ATMOS
energy

TAGE RD CROSSING		SHT 10F1
EXHIBIT "A"		
ATMOS ENERGY		
PROPOSED PERMIT PLAT		
CROSSING TAGE RD		
MONTAGUE COUNTY, TEXAS		
DRAWN BY: BAP	DATE: 05/27/2021	
SCALE: SCALE: 1"=60'	DWG. NO. TAGE RD	